

# VECTOR

## PERISTALTIC PUMPS

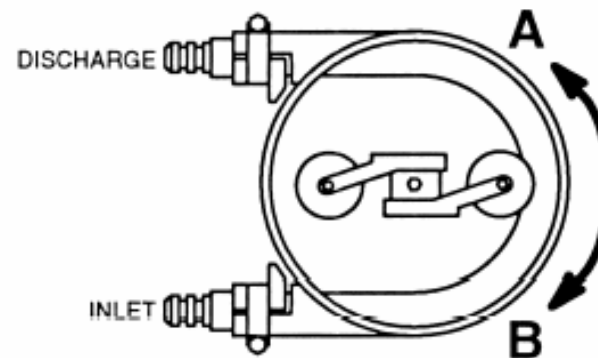

WANNER ENGINEERING, INC.

# VECTOR

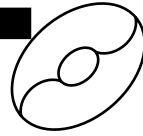

## PERISTALTIC PUMPS

### Industries Served

- Water Treatment
- Pulp & Paper
- Mining
- Paint & Polymer
- Printing
- Meat Processing
- Food & Beverage
- Wine
- Printing
- Metal Processing
- Building/Construction
- Ceramics



WANNER ENGINEERING, INC.



PERISTALTIC PUMPS

## Fluids Pumped

- Acids
- Bentonite Slurries
- Carbon Slurry
- Ceramic Slip
- Cosmetics & Creams
- Dyes & Inks
- Eggs
- Ferric Chloride
- Flavorings
- Iron Oxide Pigments
- Jams & Preserves
- Lime Slurries
- Paint
- Sodium Hydroxide
- Shampoos
- Yogurt



WANNER ENGINEERING, INC.



## PERISTALTIC PUMPS

### Peristaltic Pump Applications

- Run Dry – no seals or stators to burn up
- Sealless – hazardous or expensive fluids
- Metering – PD pump, flow per revolution
- Fluids with solids – gear pumps or plunger pumps fail
- Fluids with Abrasives – no seals or valves to wear
- Stringy Materials – No valves to clog
- Entrained air – does not cavitate pump



WANNER ENGINEERING, INC.

# VECTOR

## PERISTALTIC PUMPS

### Field Installations



WANNER ENGINEERING, INC.

# VECTOR

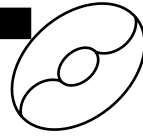

## PERISTALTIC PUMPS

### Specifications

- Pressures – Up to 200 PSI
- Flows – Up to 150 GPM
- Contamination Free Pumping
- Self Priming – Suction lifts to 20 feet
- Dry Running – Externally Lubricated
- Vacuum – Evacuates liquids & Gases



WANNER ENGINEERING, INC.



PERISTALTIC PUMPS

## Specifications – Con't

- Reversible – Easy cleaning, or filling and emptying tanks
- Solids Handling – fines to 2.5" solids
- Hose Compatibility – 6 to 7 hose materials to choose from
- Does not emulsify/ Low Shear



WANNER ENGINEERING, INC.

# VECTOR

## PERISTALTIC PUMPS

### Specifications – Con't

- Seal less – no valves to clog or seals to leak.
- Low Maintenance – Easy hose replacement
  - Clear cover for easy inspection
- Positive Displacement – Metering, output flow varies directly with speed



WANNER ENGINEERING, INC.

# VECTOR

## PERISTALTIC PUMPS

### 2000 Series (Roller Design)

- Up to 116 PSIG
- 25 – 32 RPM roller speed in 24/7 operation
- Grease Lubricated

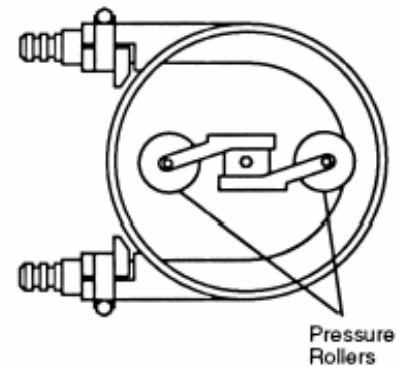
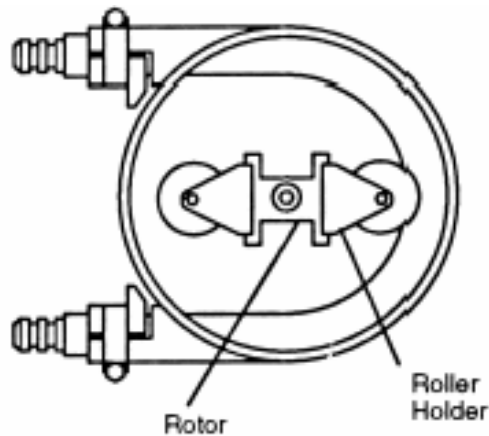

WANNER ENGINEERING, INC.

# VECTOR

## PERISTALTIC PUMPS

### 3000 Series

(Roller & Shoe Design)

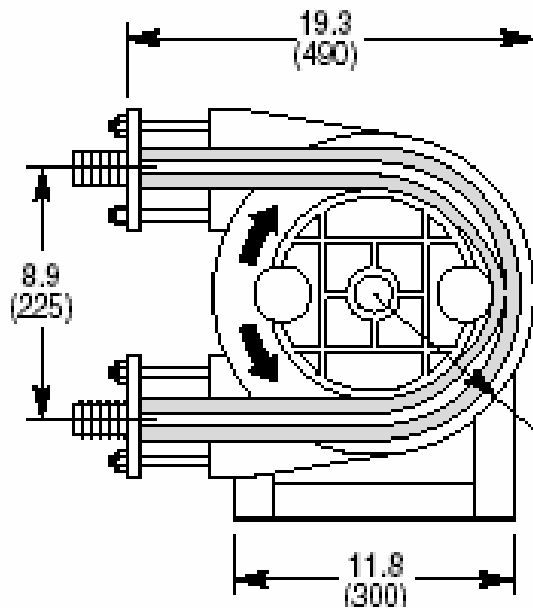

- Up to 200 PSIG
- 70 RPM Roller Speed in 24/7 Operation
- Glycerin & Glycol Lubricated
- Less Heat, less starting torque, less HP than shoe ONLY pumps



WANNER ENGINEERING, INC.

# VECTOR

## PERISTALTIC PUMPS

### MODEL 3005



### SPECIFICATIONS

- 200 PSI Discharge Pressure
- 0.5 to 9.8 GPM
- 22 Foot Suction Lift
- 100,000 Cps Fluids
- Lubricant Filled Cavity
- Shoe and roller rotor assembly



WANNER ENGINEERING, INC.



PERISTALTIC PUMPS

## Pump Selection

1. Determine Maximum Roller Speed
  - **Hours of operation per day**
  - Viscosity of the fluid
2. Select a pump that can deliver the flow at the maximum speed.
3. Select a hose compatible with fluid and that can handle the pressure or vacuum.
4. Select connector type and material
5. Select a drive – motor, gearbox, VFD



WANNER ENGINEERING, INC.



## PERISTALTIC PUMPS

### Peristaltic Pumps vs. AOD

- Have better metering accuracy
- Do not foam fluids
- Can be used to evacuate gases as well as fluids
- Do not stall
- Use less energy
- Can handle stringy material
- Can handle suspended solids
- Do not have valves to clog
- Are easier to maintain
- **Cost more initially**



WANNER ENGINEERING, INC.

## Trouble Shooting Hose Failures

- Chemical Attack
- High discharge pressure
- High suction vacuum
  - Suction Piping too small

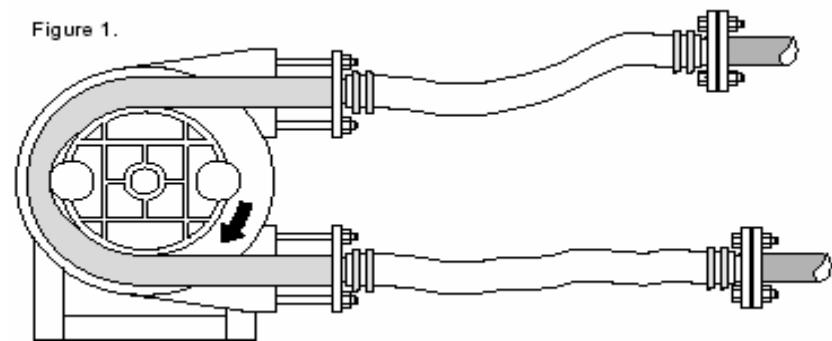

# VECTOR

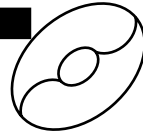

## PERISTALTIC PUMPS

### Delivery

Models 2002, 2003, 2004

- (2-7 days)

Models 2005, 2006, 2007, 2010, 3005

- (3-4 weeks normal)
- (2 weeks with expedited gear motor)

Parts and Hoses

- (Stock)



WANNER ENGINEERING, INC.